



	Safety Information.	4
	Information about the device	5
	Description of the device	5
	Intended Use	5
	Technical Data	5
	Declaration of Conformity	5
	FCC Certification	6
	IC Certification	6
	Assembly and Installation	7
	Installation on a DIN-rail	7
	Circuit diagram	7
	Operation and Setting	8
	Display and Function Keys	8
	Overview of menu structure	9
	Initial commissioning	10
	Programming	11
	Information relating to program creation	11
	Creating a new switching program	12
	Using wildcards	13
	Defining prioritisation of programs	22
	View, edit or delete program	22
	View the date list, edit or delete	23
	View the switching times, edit or delete program	24
	Delete all programs	25
	Configuration	26
	Backlight	26
	Location information (Astro)	27
	Hour-Counter	28
	PIN	31
	Set PIN	31
	Mode	32
	Set mode	33
	Bluetooth	33
	Set date and time of day	35
	Switching from Summer/Winter time	36
	Language Setting	37
	Automatic/ Manual Mode	38



Override mode	38
Switching state display	39

 Maintenance and Service.	40
Distribution partners	40
Software-Update	40

 Disposal and Recycling	41
---	----



Safety Information



Risk of Fire or Electric Shock

- ▷ Disconnect power at the circuit breaker(s) or disconnect switch(es) before installing or servicing.
- ▷ Installation and/or wiring must be in accordance with national and local electrical code requirements.
- ▷ Use supply wires 14-12 AWG, rated 75°C minimum – COPPER conductors ONLY.
- ▷ KEEP DOOR CLOSED AT ALL TIMES when not servicing.

Please note:

- National regulations and safety regulations
- Guarantee is invalidated if you tamper with the device or modify it
- Minimum diameter of the flexible lines for the connecting terminals: 1 mm²
- Maximum diameter of the flexible lines for the connecting terminals: 2.5 mm²

Read this manual and pay attention to its contents to ensure that the device works perfectly and that you can work safely with it.



Information about the device

Description of the device

Digital distribution autotimer

- Date-independent programming
- Date-dependent programming
- Pulse, cycle and random programming*
- Sunrise/sunset related programming
- Program creation by means of PC and mobile devices
- Bluetooth low energy interface

Intended Use

- The device is suitable for the following applications:
 - Lighting in private and commercial areas
 - Advertising signs
 - Street lighting
 - Shop lighting
 - Controlling devices, motors and pumps
 - Controlling roller blinds and sun blinds
 - Simulation of home presence
- Only suitable for use on dry premises
- Do not use close to devices with inductive discharge (motors, transformers, etc.)
- Only install on DIN-rails

Technical Data

You can find the technical data for the devices that are described in this manual at:

www.graesslin.de/technical-data

Declaration of Conformity

You can find the declaration of conformity for the devices that are described in this manual at:

www.graesslin.de/doc

* These functions depend on variant.



FCC Certification

FCC ID: 2AHH7-DG

This device complies with part 15 of FCC Rules . Operation is subject to the following two conditions;
(1) This device may not cause harmful interference, and (2) this device must accept any interference received, including interference that may cause undesired operation.

Labelling Requirments

The Original Equipment Manufacturer (OEM) must ensure that FCC labelling requirements are met. This includes a clearly visible label on the outside of the OEM enclosure specifying the appropriate Grässlin GmbH FCC identifier for this product as well as the FCC Notice above.

The FCC identifiers is: 2AHH7-DG

This FCC identifier are valid for Talento Smart x15 and Talento Smart x25, for details. In any case the end product must be labelled exterior with:

“Contains FCC: 2AHH7-DG”

IC Certification

IC:21619-DG

This device complies with Industry Canada’s RSS-Standards.

Operation is subject to the following two conditions;

- (1) This device may not cause harmful interference, and
- (2) this device must accept any interference received, including interference that may cause undesired operation of the device.

IC Identifiers is: IC: 21619-DG

This IC identifier are validt for Talento Smart x15 and Talento Smart x25, for details. In any case the end product must be labelled exterior with:

„Contains IC:21619-DG“

Registration numbers for individual countries can be found on page 559.

Assembly and Installation

Risk of death due to electrical shock!

Incorrect assembly and installation of the device can result in life-threatening electrical voltages.

► This product should be installed by an electric specialist according to current installation standards.

Installation on a DIN-rail

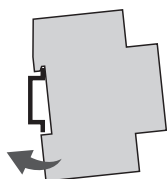

Place the device onto the DIN-rail from above at a slight angle.

1. Press it backwards until it clicks into place.

Circuit diagram

CH1 = Channel 1

CH2 = Channel 2

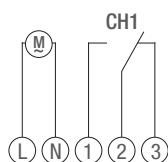

1-Channel variant

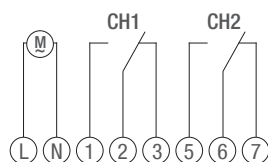

2-Channel variant

Install the device according to the circuit diagram (with one or two channels depending on the variant).



Operation and Setting

Display and Function Keys

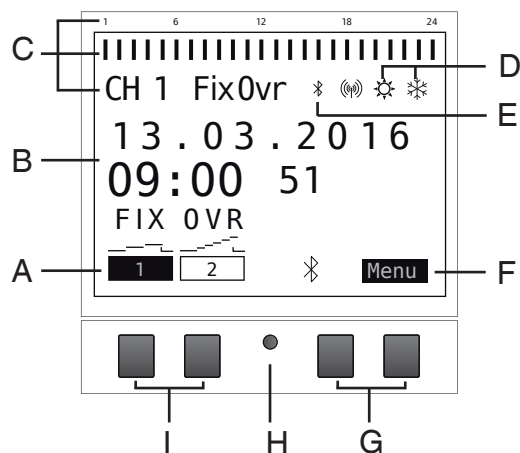

Display:

- A Function displays of the buttons on the left
- B Date and time or menu navigation
- C Programmed switching times
- D Display of summertime/wintertime
- E Bluetooth-Anzeige
- F Function displays of the buttons on the right

Buttons:

- G Buttons on right
- H Reset-Taste
- I Buttons on left

Function displays of the two buttons on the right (G):

- Menu Leave auto mode and enter programming Mode
- ESC Press briefly = Goes back one step
Press for a long time (about 2 sec) = Goes back to auto mode
- OK Make the selection and apply it
- < Undo the last input, e.g. when entering the time

Function displays of the two buttons on the left (I):

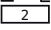
-  Channel status for Channel 1
-  Channel status for Channel 2
- ^ Page upwards in the menu
- v Page downwards in the menu
- Press briefly = The displayed value (hour, minute, etc.) is decremented by 1/
Press for a long time (about 2 sec) = fast scrolling
- + Press briefly = The displayed value (hour, minute, etc.) is incremented by 1/
Press for a long time (about 2 sec) = fast scrolling



Overview of menu structure

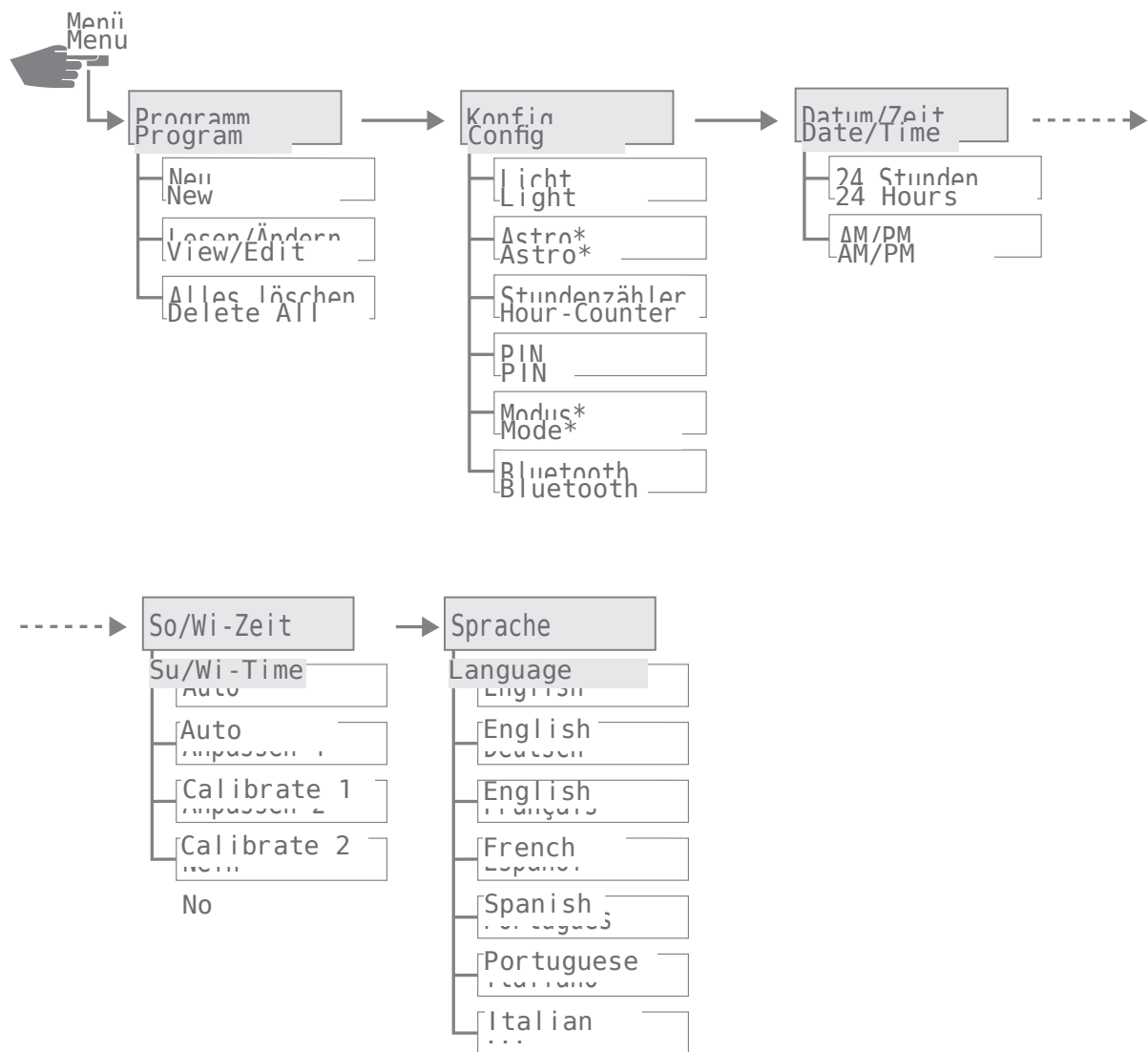

* These functions depend on the variant.



Initial commissioning

When delivered, the device is in automatic mode with default settings for time, date and language (English).

When the menu buttons are first operated, a wizard walks you through the basic settings that you can check during initial commissioning and adjust if necessary.

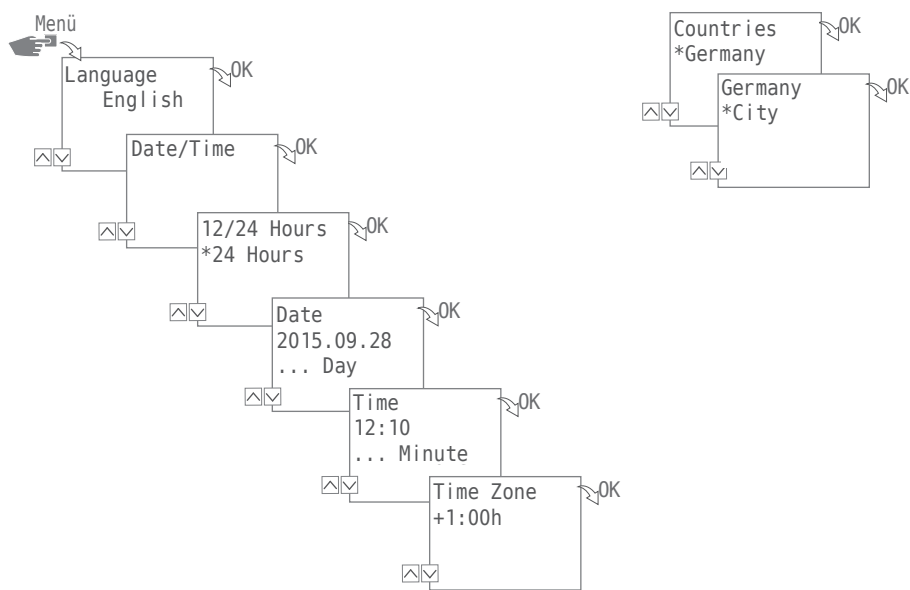

The following settings are queried during initial commissioning:

- Language; see „Language Setting“ auf Seite 77
- Date and time of day; refer to „Set date and time of day“ auf Seite 75
- Location information (Country, Coordinates) for astro calculations; refer to „Location information (Astro)“ auf Seite 67

* These functions depend on the variant.



Programming



Switch-off commands have priority over switch-on commands.

INFORMATION RELATING TO PROGRAM CREATION

The device is programmed in the following steps:

- Setting up data and/or date ranges
You can specify on which day and/or at what time of day (date from ... to) that the device is turned on or off in this menu.
- Setting the function and switching time
Under this menu item, you specify which switching command is performed at which time (ON, OFF, pulse*, cycle*, random*). This can be specified per channel for different date ranges or as date independent.

* These functions depend on the variant.



CREATING A NEW SWITCHING PROGRAM

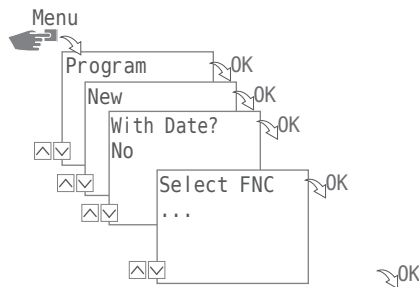

Programming without date

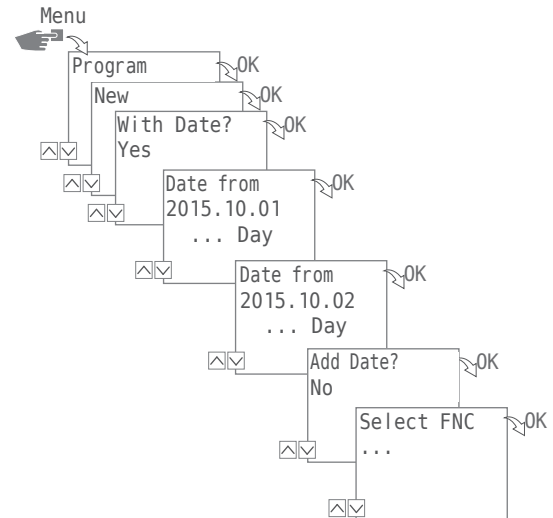

Programming with date

To create a new switching program, press the key Menu:

1. Select Program and confirm with OK.
2. Select New and confirm with OK.



The number of available program memory spaces is displayed briefly (PXXX). The number of available switching channel memory spaces (Dxxx) then appears.

The available memory spaces depend on the variant of the device.

3. In step With Date? specify with

- No and OK, the device should be programmed without date range.
The switching command is valid for date independent.
Proceed with action step to step 4.
- Specify Yes and OK so that the device will be programmed with a date range.
The switching commands are valid for the dates and/or time periods which are defined in the programming, also refer to Seite 53.
You can define multiple date ranges. If the time periods have been determined, end the query after the last date range with No.



If you have configured the location information (astro function) in the device, then you can choose whether the device should be switched directly to sunrise and sunset with one change via the day limit. The astro function is not available in all device variants, also refer to „Location information (Astro)“ auf Seite 67.



4. In step SELECT FCT (FCT = Function), specify the type of switching command:
 - ON
Select the times at which a channel should be switched on → ①.
 - OFF
Select the times at which a channel should be switched off → ②.
 - Pulse
Select the settings for pulse programming → ③.
 - Cycle
Select the settings for cycle programming → ④.
 - Random ON
Select the settings for random programming ON → ⑤.
 - Random OFF
Select the settings for random programming OFF → ⑥.
5. Select the desired function and confirm with OK.



The number of available switching command memory spaces appears (CXXX).
The available memory spaces depend on the variant of the device.

USING WILDCARDS

You can use wildcards when entering the date. This allows you to program recurring switching times that are always to be carried out, for example, always the first of the month. In place of annual, monthly or daily numbers, choose the wildcards **** for the year and ** for the month and day instead.

Below you see how date entries appear and how you can use wildcards:

- 2016.03.13 - 2016.03.13
The switching command is executed only on 13 March 2016.
- 2016.03.13 - 2016.03.20
The switching command is executed between 13 March 2016 and 20 March 2016.
- 2016.**.13 - 2016.**.13
The switching command is executed the 13th of every month in 2016.
- ****.**.01 - ****.**.01
The switching command is always executed annually on the first day of a month.



The wildcards for the year can be found when you scroll through the current year number in the date entry program. The wildcards for the month can be found between December and January.



Ⓐ Programming command ON

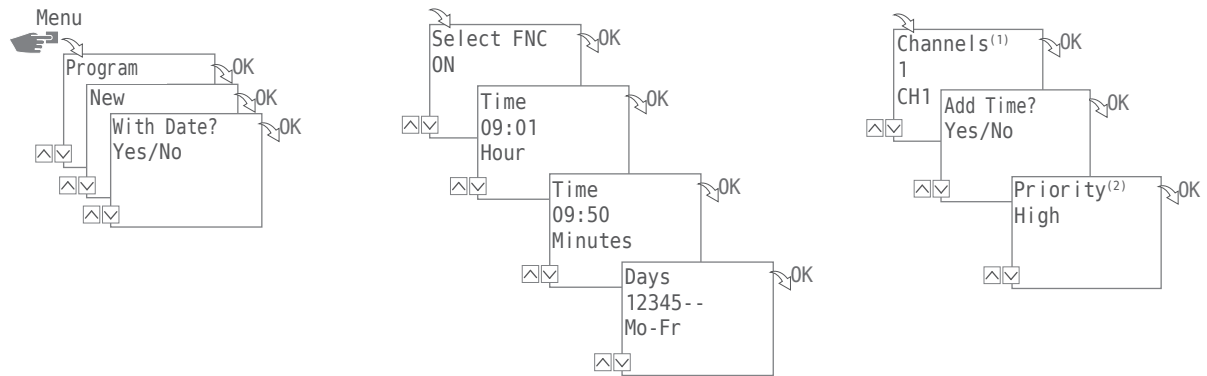

1. Press the Menu button:
2. Select Program and confirm with OK.
For clarification of the following action steps, see flow chart.
3. Select New and confirm with OK.
4. In step With Date? ,specify whether the device is to be activated on a certain date and - if yes - confirm with OK (also refer to Seite 52).
5. Select ON and confirm with OK.
6. Enter hour and minute of the switch-on time (+/-) and confirm each with OK.
NOTE: The data for sunrise and sunset should be considered in connection with the astro-variant. The choice of these parameters is between 11 p.m. and midnight.
7. Set the weekday(s) (+/-) to which the switching time should apply, and confirm with OK.
NOTE: The weekdays 1-5, 6-7 and 1-7 are preset. Individual weekdays can be set (+/-) under "Select days".
8. Select channel⁽¹⁾ (+/-) for which the switching time should be set, and confirm with OK.
NOTE: The plus sign stands for an active, the minus sign for an inactive channel.
9. Select YES to create an additional switching time, or select NO to determine the possible priority ⁽²⁾.



⁽¹⁾ The channel selection is only available with 2-channel timers

⁽²⁾ The choice of priority is only possible in advanced mode; refer to „Defining prioritisation of programs“ auf Seite 61.



Ⓑ Programming command OFF

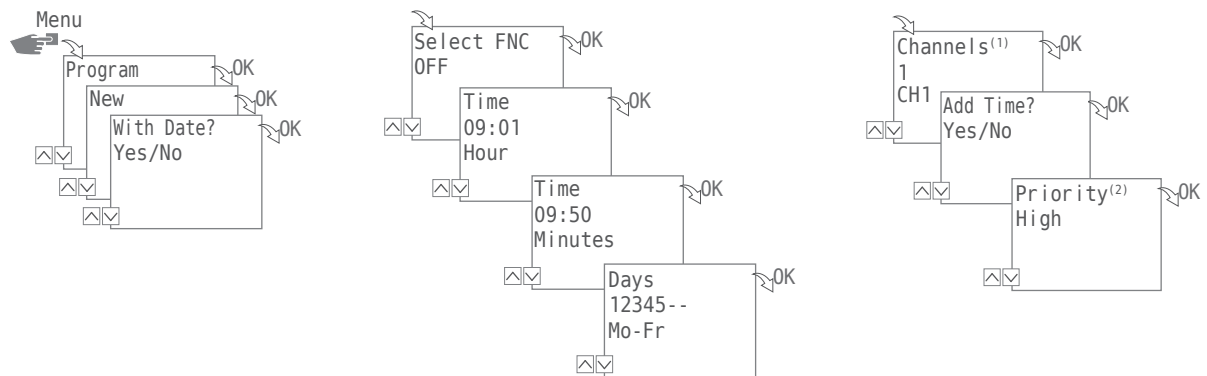

1. Press the Menu button:
2. Select Program and confirm with OK.
For clarification of the following action steps, see flow chart.
3. Select New and confirm with OK.
4. In step With Date? ,specify whether the device is to be activated on a certain date and - if yes - confirm with OK (also refer to Seite 52).
5. Select OFF and confirm with OK.
6. Enter hour and minute of the switch-off time (+/-) and confirm each with OK.
NOTE: The data for sunrise and sunset should be considered in connection with the astro-variant. The choice of these parameters is between 11 p.m. and midnight.
7. Set the weekday(s) (+/-) to which the switching time should apply, and confirm with OK.
NOTE: The weekdays 1-5, 6-7 and 1-7 are preset. Individual weekdays can be set (+/-) under "Select days".
8. Select channel⁽¹⁾ (+/-) for which the switching time should be set, and confirm with OK.
NOTE: The plus sign stands for an active, the minus sign for an inactive channel.
9. Select YES to create an additional switching time, or select NO to determine the possible priority⁽²⁾ .



⁽¹⁾ The channel selection is only available with 2-channel timers

⁽²⁾ The choice of priority is only possible in advanced mode; refer to „Defining prioritisation of programs“ auf Seite 61.



© Pulse programming

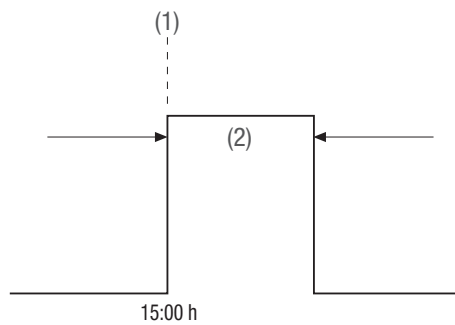

(1) Start time

(2) Duration



This feature is not available in all variants of the device.

A pulse switching command consists of:

- Start time
- Duration = switching ON
 - shortest switching time ON = 1 second
 - longest switching time ON = max. 2 hours

Example:

Channel 1 will be switched daily from Monday to Friday at 15:00 for a duration of 30 seconds.

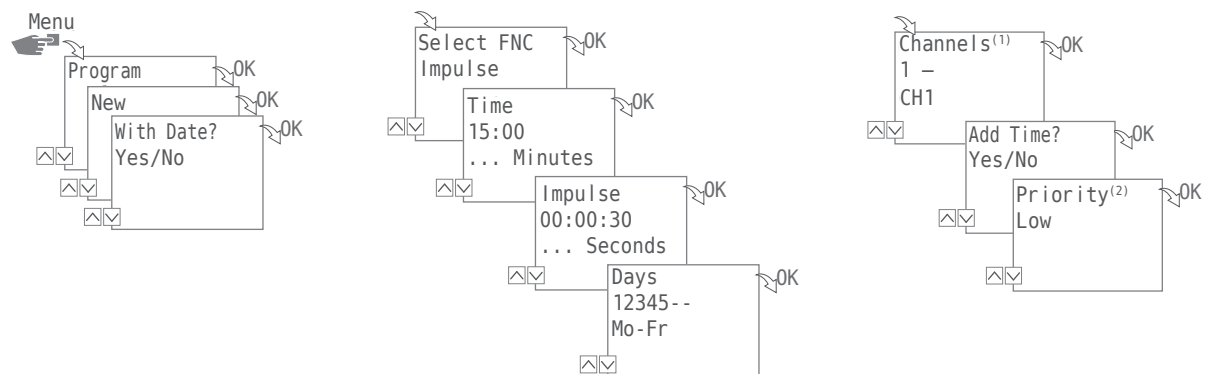



1. Press the Menu button:
2. Select Program and confirm with OK.
For clarification of the following action steps, see flow chart.
3. Select New and confirm with OK.
4. In step With Date? ,specify whether the device is to be activated on a certain date and - if yes - confirm with OK (also refer to Seite 52).
5. Select Impulse and confirm with OK.
6. Enter hour and minute of the start time (+/-) and confirm each with OK.
NOTE: The data for sunrise and sunset should be considered in connection with the astro-variant.
The choice of these parameters is between 11 p.m. and midnight.
7. Enter hour(s), minute(s) and second(s) of the impulse duration (+/-) and confirm each with OK.
8. Set the weekday(s) (+/-) to which the switching time should apply, and confirm with OK.
NOTE: The weekdays 1-5, 6-7 and 1-7 are preset. Individual weekdays can be set (+/-) under "Select days".
9. Select channel⁽¹⁾ (+/-) for which the impulse should be set, and confirm with OK.
NOTE: The plus sign stands for active, the minus sign for an inactive channel.
10. Select YES to create an additional switching command or select NO to determine the possible priority ⁽²⁾ .



⁽¹⁾ The channel selection is only available with 2-channel timers

⁽²⁾ The choice of priority is only possible in advanced mode; refer to „Defining prioritisation of programs“ auf Seite 61.



④ Cycle programming

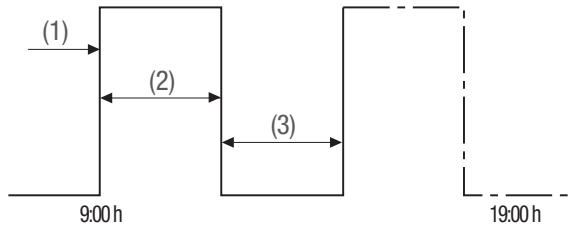

(1) Start time

(2) Duration ON

(3) Duration OFF



The cycle programming is only possible in advanced mode; refer to „Mode“ auf Seite 72.

A cycle switching command consists of:

- Start time
- Period ON = Switching ON
- Period OFF = Switching OFF

Example:

Channel 1 is switched on from Monday 9:00 to Friday 19:00 every 30 minutes for 10 minutes.

Start time 9:00

Duration ON 10 minutes

Duration OFF 20 minutes

Separate OFF command 19:00



To end the cycle, an independent command of OFF must be set.

A nesting of cycle programs is not allowed

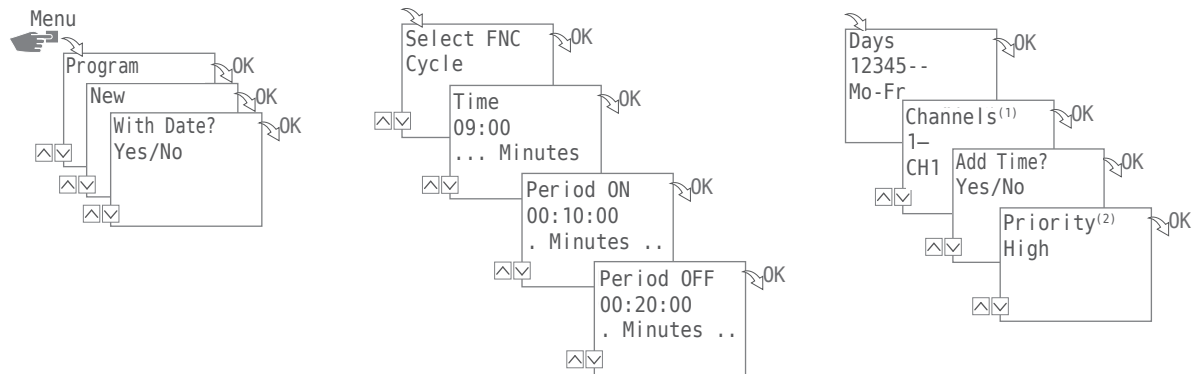

1. Press the Menu button:
2. Select Program and confirm with OK.
For clarification of the following action steps, see flow chart.
3. Select New and confirm with OK.
4. In step With date? determine whether the device should be activated on a certain date and - if yes - confirm with OK (also refer to Seite 52).
5. Select Cycle and confirm with OK.
6. Enter hour and minute of the start time (+/-) and confirm each with OK.
7. Enter period ON (+/-) and confirm each with OK.
8. Enter period OFF (+/-) and confirm each with OK.
9. Select weekdays (+/-) on which the cycle should be started and confirm with OK.
NOTE: The weekdays 1-5, 6-7 and 1-7 are preset. Individual weekdays can be set (+/-) under "Select days".
10. Select channel⁽¹⁾ (+/-) for which the cycle should be set, and confirm with OK.
NOTE: The plus sign stands for active, the minus sign for an inactive channel.
11. And choose possible Priority⁽²⁾.



Program the command OFF in Menu FKT end the cycle switching command.

⁽¹⁾ The channel selection is only available with 2-channel timers

⁽²⁾ The choice of priority is only possible in advanced mode; refer to „Defining prioritisation of programs“ auf Seite 61.



⑤ Random programming

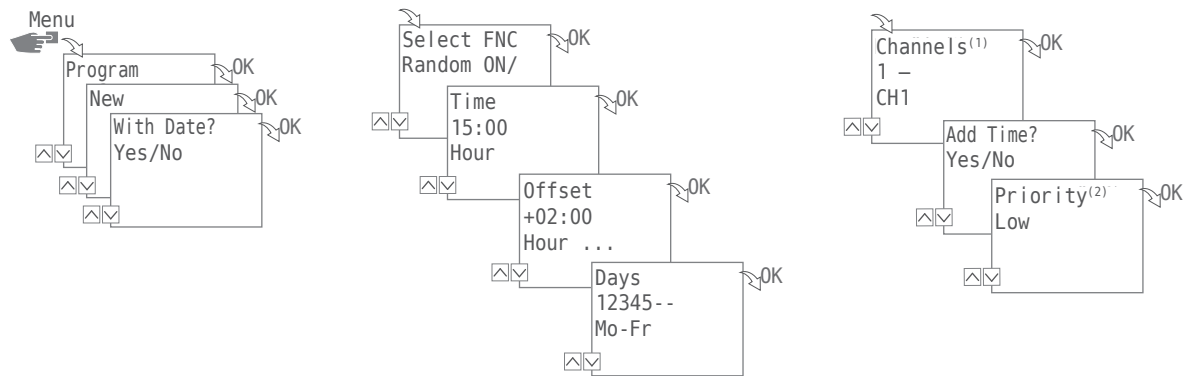

Random programming is possible only in advanced mode.

Example: Random ➔ 15:00 ➔ +02:00 ➔ 1 2 3 4 5 ➔ 1

Channel 1 is switched on Monday to Friday between 15:00 and 17:00. The exact switch-on time point is random in this range.

1. Press the Menu button:
2. Select Program and confirm with OK.
For clarification of the following action steps, see flow chart.
3. Select New and confirm with OK.
4. In step With date determine whether the device should be activated on a certain date and - if yes - confirm with OK (also refer to Seite 52).
5. Select Random ON or Random OFF and confirm with OK.
NOTE: The period of the random switching is defined with ± 2 hours.
6. Enter hour and minute of the start (+/-) and confirm each with OK.
7. Enter hour and minute of the range of the random programming (+/-) and confirm each with OK.
8. Set weekday on which the device should randomly switch and confirm with OK. NOTE: The weekdays 1-5, 6-7 and 1-7 are preset. Individual weekdays can be set (+/-) under "Select days".
9. Set the channel⁽¹⁾ which is to be programmed, and confirm with OK.
NOTE: The plus sign stands for active, the minus sign for an inactive channel.
10. And choose possible Priority⁽²⁾.



⁽¹⁾ The channel selection is only available with 2-channel timers.

⁽²⁾ The choice of priority is only possible in advanced mode; refer to „Defining prioritisation of programs“ auf Seite 61.



DEFINING PRIORITISATION OF PROGRAMS

You specify the order in which the programs of the device should be run using prioritisation. You can thus execute a daily switching command, but can define via a higher priority, that, for example, other switching times of the device are valid during holidays.



The choice of priority is only possible in advanced mode.

By default, the priority is specified as follows:

- Without date → very low
- With date reference → medium
- With individual date → high

The following priorities can be set:

- Very Low
- Low
- Medium
- High
- Very High

Example:

A daily program switches on the device every day from morning 08:00 to 17:00 in the afternoon. If, for example, you do not want the device to switch on on weekends or a holiday, create a program with a higher priority for these days. This program takes precedence over the other settings.



VIEW, EDIT OR DELETE PROGRAM

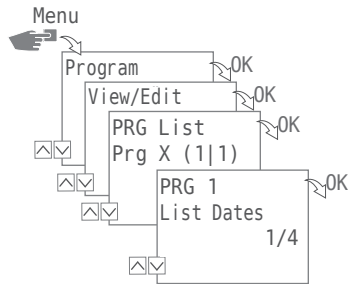

In order to view, edit or delete a program, press the Menukey:

1. Select **Program** and confirm with **OK**.
2. Select **View/Edit** and confirm with **OK**.
3. Select program and confirm with **OK**.
4. Select the list (**Date Entries**, **Switching Times**, **Priority**) which you want to view or edit yourself, or select **Delete program** to delete the selected program.



The choice of priority is only possible in advanced mode.



VIEW THE DATE LIST, EDIT OR DELETE

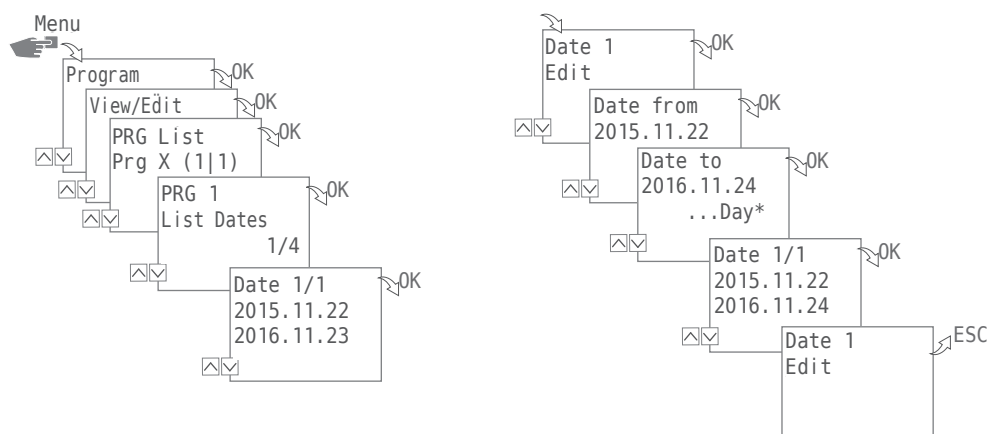

In order to view, edit or delete a program, press the Menu key:

1. Select Program and confirm with OK.
2. Select View/Edit and confirm with OK.
3. Select program and confirm with OK.
4. Select List Dates and confirm with OK.
5. Select a date which you want to view, edit or delete and confirm with OK.
6. Select Edit, Advanced, Delete or All delete and confirm with OK.



Delete: The selected date (from ... to) will be deleted.

All delete: All the data in the date list will be deleted.



VIEW THE SWITCHING TIMES, EDIT OR DELETE PROGRAM

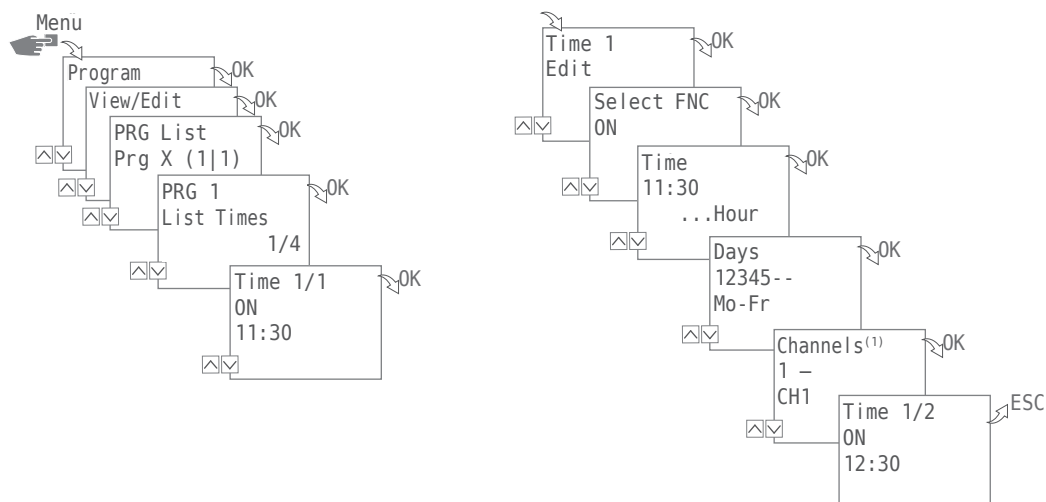

In order to view, edit or delete the switching times of a program, press the Menu key:

1. Select Program and confirm with OK.
2. Select View/Edit and confirm with OK.
3. Select program and confirm with OK.
4. Select List Times and confirm with OK.
5. Select the switching time which you want to view, edit or delete and confirm with OK.
6. Select Edit, Advanced, Delete or All delete and confirm with OK.



Delete: The selected switching time (e.g., ON / OFF, time, days, channels⁽¹⁾, impulse or cycle) will be deleted.

All delete: All switching times will be deleted.

⁽¹⁾ The channel selection is only available with 2-channel timers



DELETE ALL PROGRAMS

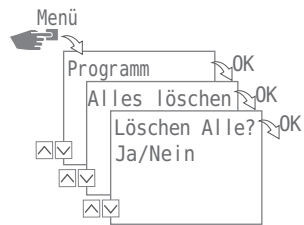

1. Press the Menu button.
2. Select Program and confirm with OK.
3. Select Delete All and confirm with OK.
4. Select Yes and confirm with OK.



Configuration

BACKLIGHT

In the **L i g h t** menu, you specify how long the backlight stays on after the last key press.

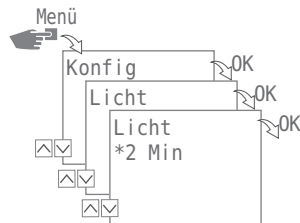

The following settings are possible:

- **Fix ON**
The backlight of the display remains on continuously.
- **2 Minutes**
The backlight of the display is automatically switched off two minutes after the last keystroke.

1. Press the **Menu** button.
2. Select **Con f i g** and confirm with **OK**.
3. Select **L i g h t** and confirm with **OK**.
4. Select the desired setting and confirm with **OK**.



LOCATION INFORMATION (ASTRO)

You define the location information in the Astro menu.



This feature is not available in all variants of the device.

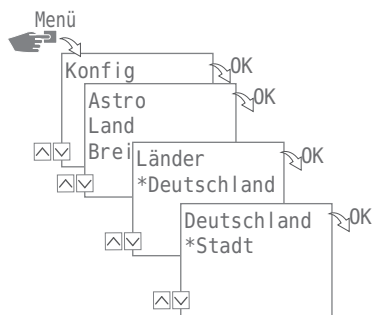

The following settings are possible:

- Country
Country name and city of the location.
- Coordinates
Latitude and longitude of the location.

1. Press the Menu button.
2. Select Config and confirm with OK.
3. Select Astro Menu and confirm with OK.
4. Select sub menu Countries or Coordinates and confirm with OK.
5. Assume the settings and confirm with OK.



HOURL-COUNTER

Reading hour meter

You can see how many operating hours your distribution switching timer is set for in Menu Read out hour meter .

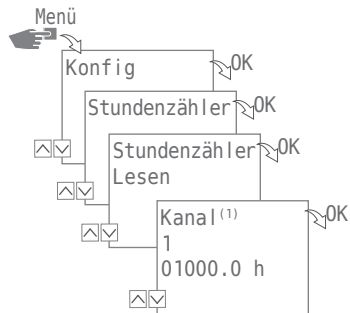

1. Press the Menu button.
2. Select Konfig and confirm with OK.
3. Select Hour Counter and confirm with OK.
4. Select Read out and confirm with OK.
5. Select the desired channel.



⁽¹⁾ The channel selection is only available with 2-channel timers



Reset hour meter

You can set the hour meter to 0 in the Reset menu.

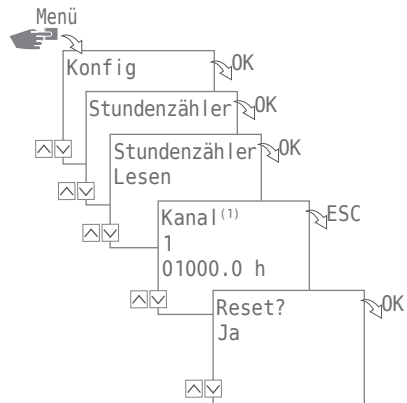

1. Press the Menü button.
2. Select Konfig and confirm with OK.
3. Select Hour Counter and confirm with OK.
4. Select Read out and confirm with OK.
5. Select the desired channel.
6. Select ESC and confirm the reset with OK.



⁽¹⁾ The channel selection is only available with 2-channel timers



Service meter

You can specify the number of operating hours that will pass before a service message will be displayed for a channel in the Hour Counter Service menu. This is shown in the display as soon as the counter has reached the hour value set by you.

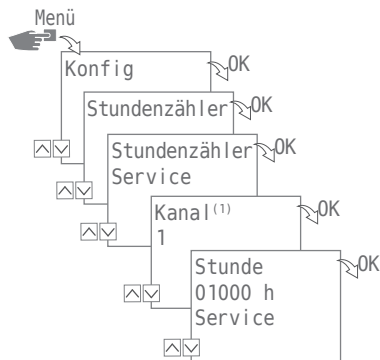

1. Press the Menu button.
2. Select Konfig and confirm with OK.
3. Select Hour Counter and confirm with OK.
4. Select Service and confirm with OK.
5. Select the channel⁽¹⁾ and confirm with OK.
6. Set count value and confirm with OK.



⁽¹⁾ The channel selection is only available with 2-channel timers



PIN

You specify whether a PIN entry is required for setting the device in the P I N menu.
The following settings are possible:

- No P I N
Entering a PIN is not required to change the settings of the device.
- P I N Enter
Entering a PIN is required to change settings of the device.

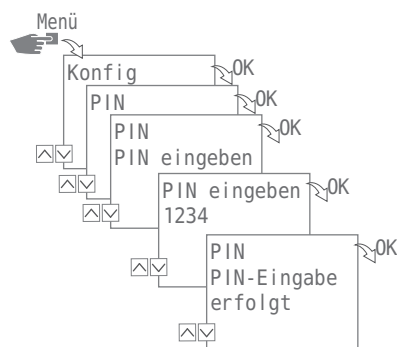

SET PIN

1. Press the Menu button.
2. Select Conf i g and confirm with OK.
3. Select P I N and confirm with OK.
4. Select NO P I N or P I N and confirm with OK.
5. For selection ENTER P I N ,enter (+/-) the PIN and confirm with OK.



MODE

You specify whether you want to only use the standard functions or the advanced functions of the device in the Mode menu.

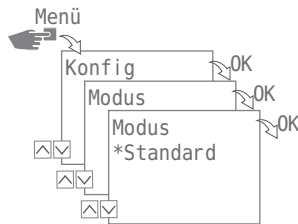

The following settings are possible:

- Standard

The following functions are available:

- ON / OFF Command
- Sunrise and sunset related programming (only for devices with astro function)
- Automatic prioritisation

- Advanced

The following functions are available:

- ON / OFF Command
- Sunrise and sunset related programming (only for devices with astro function)
- Automatic prioritisation
- Pulse programming
- Cycle programming
- Random programming
- User-defined prioritization

SET MODE

1. Press the Menu button.
2. Select Konfig and confirm with OK.
3. Select Modus and confirm with OK.
4. Select Standard or Advanced setting and confirm with OK.



BLUETOOTH



The talento smart mobile app is available for both Android as well as iOS devices.



Certain functions of the device can be controlled by Bluetooth via the Bluetooth menu (smart phone, tablet, etc.).

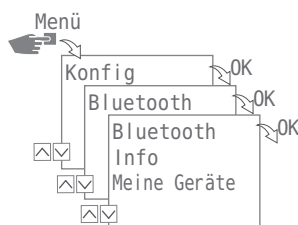

The following settings are possible:

- Smart Link
 - MAC-Address
 - Device name
- General
 - Version number of software
 - Serial number of device

CREATE BLUETOOTH CONNECTION

1. Press the Bluetooth button on the device (DIN-rail time switch).
The Bluetooth icon will flash for two minutes. If a mobile device or a PC connects, the Bluetooth icon remains continually visible.
2. Searching the app for new devices.
If the device is found, it is displayed in the app in the list of available devices.



If a connection is established for the first time, the device connects automatically as soon as the range of the Bluetooth connection has been achieved. You can then control the time switch with the mobile device.

If the timer switch hour is protected via a PIN, then this must be entered on the mobile device.



DISPLAY DURING DATA TRANSMISSION

The following appears on the display of the time switch during the transmission of programs or configuration from a mobile device:

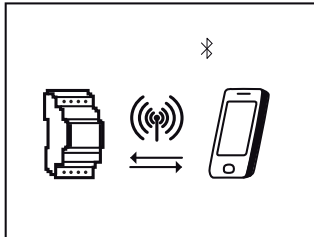



Set date and time of day

You specify the format for the display of the time in the Date/Time menu.

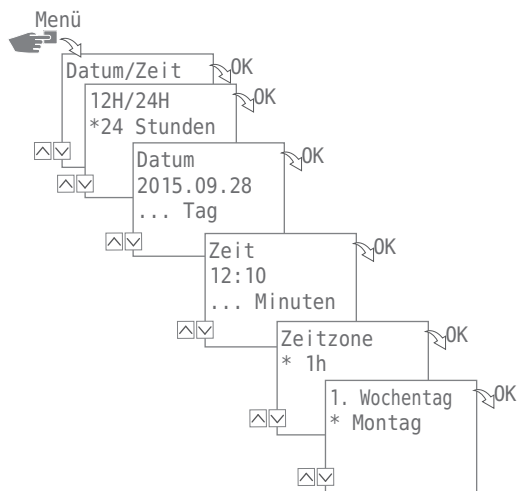

The following settings are possible:

- 24 Hours
The time is displayed in 24-hour format.
- AM/PM
The time is displayed in 12-hour format:
 - AM = morning
 - PM = afternoon

1. Press the Menu button.
2. Select Date/Time and confirm with OK.
3. Select the desired setting (v/^) and confirm with OK.
4. Enter data according to the setting 24 Hours or AM/PM:
 - Date
 - Clock
 - Time Zone
 - First weekday

Example:

1st day = Sunday ... 1 - 5 = Su - Th

1st day = Monday ... 1 - 5 = Mo - Fr

[illegible]

- Auto
Factory setting of the legal requirement (USA or EU). This is recalculated each year.
- Adjust 1
Automatic programming:
The Summer/Winter time is automatically recalculated for each year.
 - The switchover takes place on the first Sunday of the selected month if the entered date is between the 1st and 15th.
 - The switchover takes place on the last Sunday of the selected month if the entered date is between the 16th and 31st.
 - The changeover takes place on the respective Sunday from 2 to 3 am (summertime) or from 3 to 2 am (wintertime).
- Adjust 2
Manual programming:
Switching always takes place every year on the same date entered.
- No
No switching.

- 36



Language Setting

You specify the language of the display texts in the Language menu.

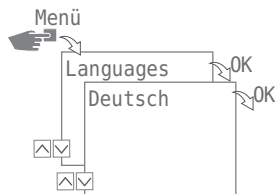

1. Press the Menu button.
2. Select Language and confirm with OK.
3. Select the desired language and confirm with OK.



Automatic/ Manual Mode

Set the operating mode in which the device is to be operated via the left function key:

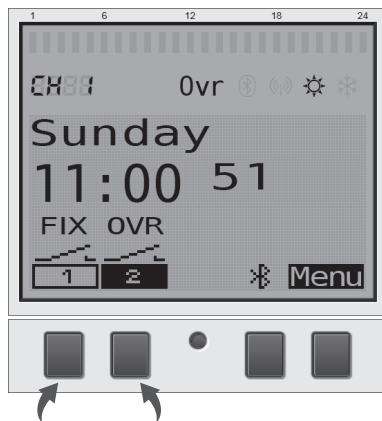

The following settings are possible:

- Permanently ON (FIX)
- Permanently OFF (FIX)
- Override mode (OVR)
- Automatic mode

To adjust the channel state for channel 1 or channel 2, press the appropriate left function button until the desired mode is selected.

OVERRIDE MODE

The override mode (temporarily overrides a running program) allows the user to terminate the running program early or to start a later start-up program prematurely. This depends on the current channel status. The override function is valid only for the current program and is retained until the next program change. Then the device will return to automatic mode.



SWITCHING STATE DISPLAY

As an example for channel 1, the switching status display appears as follows:



Channel Fix OFF



Channel Fix ON



Override ON



There is no display via the icon for the channel in automatic mode.

From the automatic mode, you can make the following settings using the corresponding function key for channel 1 or channel 2, taking into account the starting point:

- ON
 - Press 1x = Override OFF
 - Press 2x = Channel Fix OFF
 - Press 3x = Channel Fix ON
- OFF
 - Press 1x = Override ON
 - Press 2x = Channel Fix ON
 - Press 3x = Channel Fix OFF



Maintenance and Service

Distribution partners

You can find our distributor partners at the following address:

www.graesslin.de/distributors

Software-Update

You can find current software updates at the following address:

www.graesslin.de/software

The installed version can be found under the Bluetooth settings, refer to „Bluetooth“ auf Seite 73.



Disposal and Recycling



You must correctly dispose of devices, batteries/rechargeable batteries or packaging materials according to legal provisions and ordinances.

Please pay attention to the information below relating to the disposal of defective system components or of the system itself according to the useful product life:

- Carry out disposal correctly, i.e. separated according to the material groups of the parts to be disposed of.
- Never put batteries/rechargeable batteries (Directive 2006/66/EC), electrical or electronic scrap in with domestic refuse. Use appropriate depots.
- Always carry out disposal in an environmentally friendly way and in accordance with any local statutes or laws.

Registration numbers

- Canada
FCC ID: 2AHH7-DG
IC:21619-DG

- Chile
SUBTEL: 7665/DO/No° 32967/F26

- India
NR-ETA-/4573

- Israel
64-04560 משרד אישור פלחוני של משרד התקשורת
אשרור להחליף את המסמך הקודם של המשרד לה
למשותב כל שינוי מכני אחרי

- Singapore

Complies with
IDA Standards
N3093-16

- Thailand

อุปกรณ์โทรคมนาคมนี้เป็นไปตามข้อกำหนดของคณะกรรมการกิจการโทรคมนาคมแห่งชาติ